



Maps and Visitor Information

General Visiting Hours

1-8:30 p.m. (*Rehabilitaiton Unit 2:30-8:30 p.m.*)

Intensive Care Unit

Immediate family members may visit (older than 13yrs. old)
8 a.m.-2 p.m. , 4-6 p.m. and 8-10 p.m.

Maternity

Hours are based on patient request.

Short Stay

1-8:30 p.m. Parents may visit at any time. 5 North Rehab, 2:30-8:30 p.m.

Café Josef

Hot Breakfast 6:45-10:30 a.m., M-F and 7-10 a.m., on weekends;
Lunch 11 a.m.-1:30 p.m., M-F and 11 a.m.-6:30 p.m., on weekends;
Dinner 4:30-7:30 p.m., M-F.

Gift Shop

Monday-Thursday 8:30 a.m.-7:30 p.m., Friday - 8:30 a.m.-4:30 p.m.

For the convenience of visitors, the Gift Shop and the Food Court are located on the first level of the Medical Mall.

Main

816-942-4400

Patient Information

816-943-2768

Emergency Department

816-943-2710

Call Center

816-9HEALTH (943-2584)

Security

816-943-3000

General visiting hours end at 8:30 p.m.

After visiting hours all visitors will be required to enter the facility through the Emergency Department.

Any visitor staying in the building past 8:30 p.m. must receive a visitor badge from the Security Department.





Elevators



Stairs



Restrooms

Medical Mall

- 7 Cardiac Pet Scan
- 4 Carondelet Pharmacy
- 1 Café Josef
- 3 Gift Shop
- 6 Laboratory
- 5 Sleep Lab
- 2 Volunteers/Auxiliary

Medical Center

- 8 St. Joseph Medical Center Administration
- 16 Carondelet Heart Institute Registration/Waiting Room
- 14 Chapel
- 18 Flower Desk
- 9 Carondelet Health Administration
- 10 Human Resources
- 11 Medical Museum
- 15 Medical Records (*Release of Information*)
- 12 Outpatient MRI/CT/Mammography
- 17 Personal Heart Advocate
- 19 Pacemaker Clinic
- 13 Spiritual Care

Community Center for Health and Education

- 23 Abell/Lorenz Room
- 22 Alex George Memorial Auditorium
- 24 CSJ Room
- 20 G.I. Endoscopy Lab/Infusion Clinic
- 25 Kelleher/McDonnell Room
- 21 Library
- 26 Organizational Development

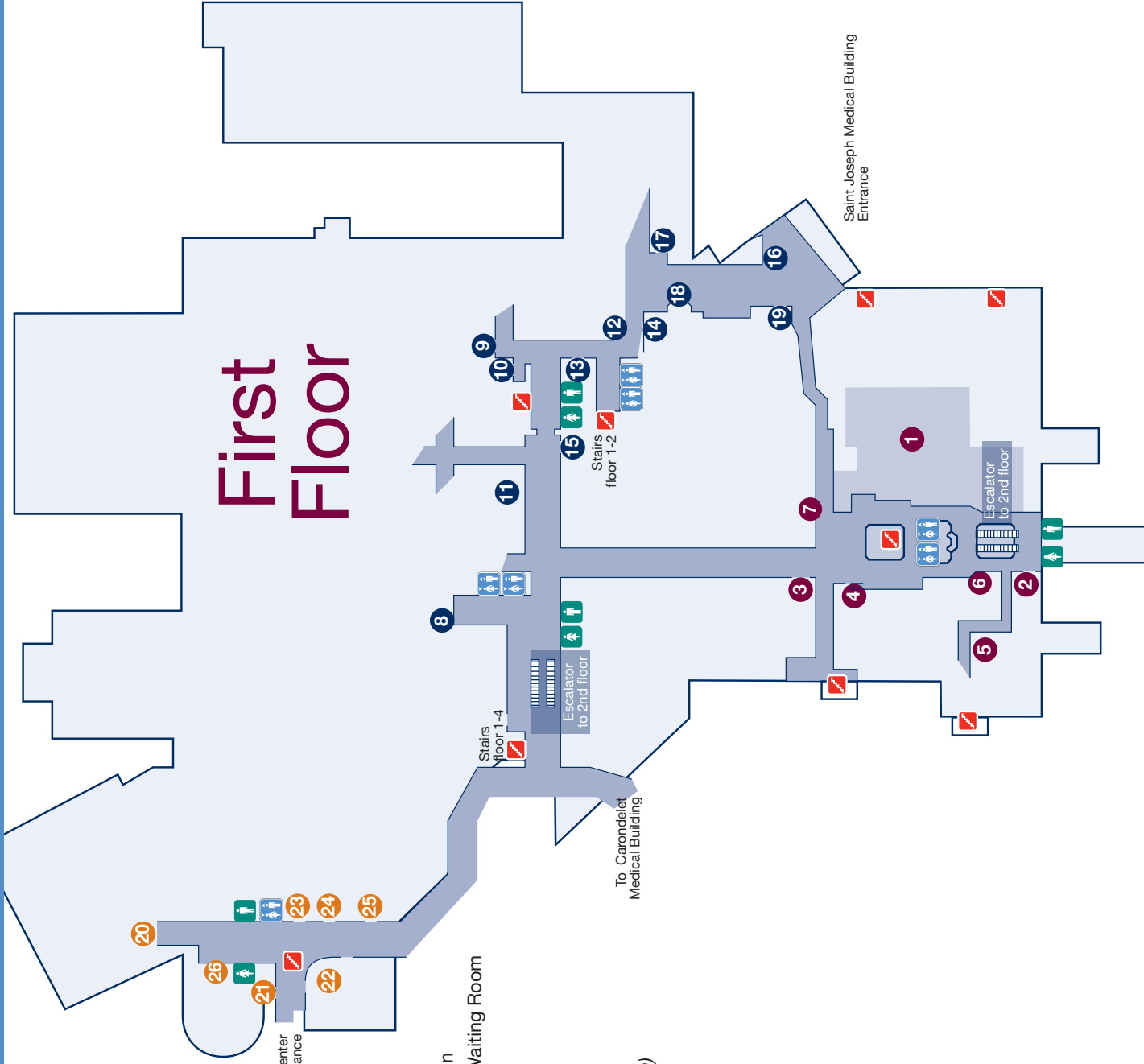

Medical Mall

- 6 Imaging/Radiology/MRI Waiting
- 1 Information Desk
- 7 Foundation
- 5 Medical Mall Surgery
- 3 Outpatient Rehabilitation & Sports Medicine Center
- 4 Pain Management Clinic
- 2 Registration/Pre-Admission Services /Business Office/Central Scheduling

Medical Center

- 19 Admissions Unit
- 8 Cardiology Diagnostic Services
- 26 Carondelet Heart Institute Classrooms
- 11 Cath Lab/Pre-Op/Recovery
- 9 Cath Lab Waiting Room
- 24 CCU
- 25 CCU/Preop Waiting Room
- 27 Diabetes Services
- 14 Emergency Entrance
- 15 Emergency Waiting
- 17 Hyperbaric Oxygen of K.C.
- 18 Neurodiagnostics/Seniors Clinic
- 10 Nuclear Medicine
- 21 PACU
- 22 Pre-Op Holding Area
- 16 Public Safety
- 13 Radiology
- 23 Respiratory Care
- 12 Surgery Holding
- 20 Surgery Waiting

Community Center for Health and Education

- 30 Cardiac/Pulmonary Rehab & Classroom
- 32 Greenlease Room
- 29 ICU Guest Sleep Rooms
- 28 Intensive Care Unit
- 33 Rose Room
- 31 Quality Resources



Elevators



Stairs



Restrooms

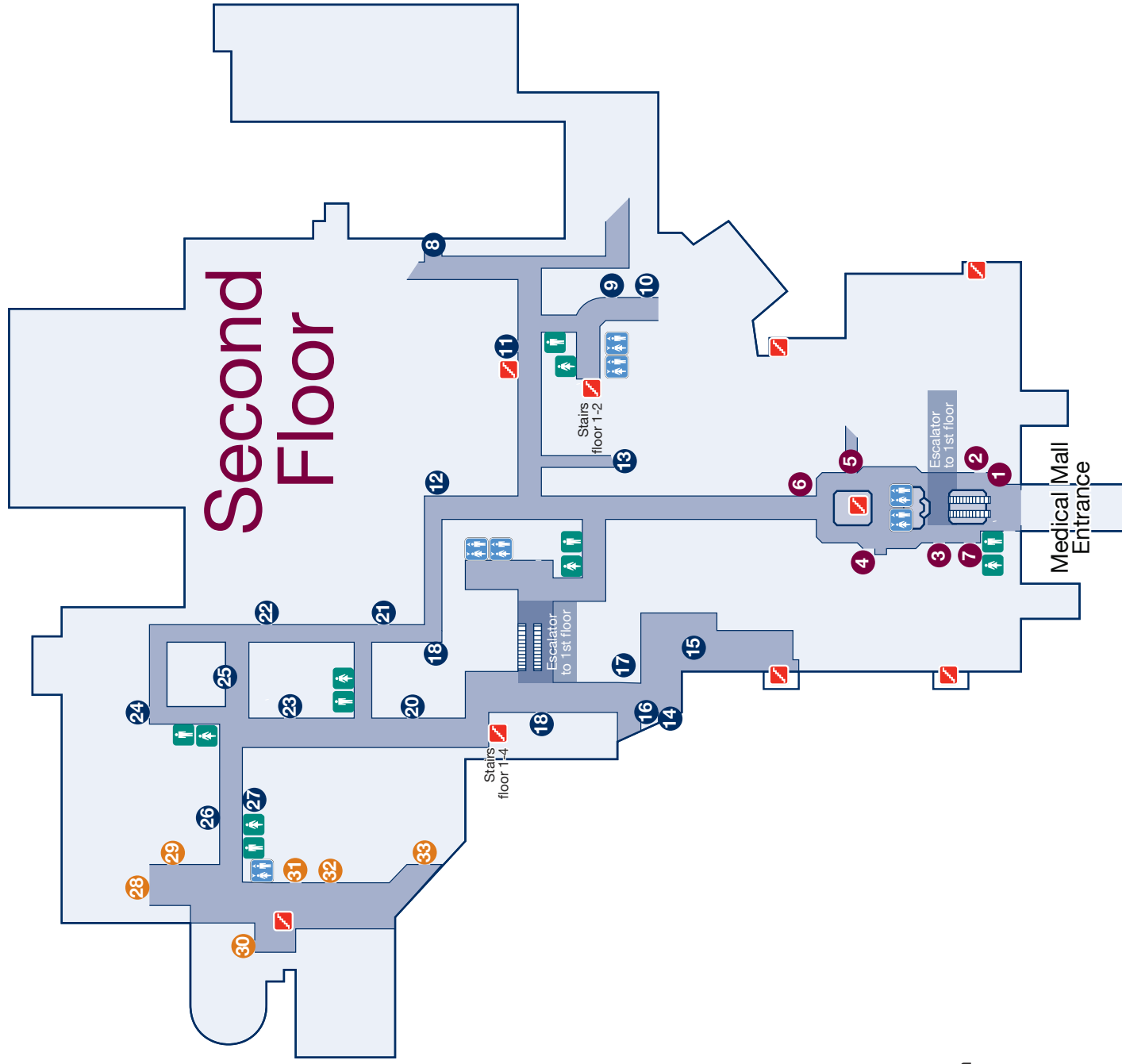

3rd Floor

- 1 3 North
- 2 3 East - Labor & Delivery
- 3 3 South Postpartum
- 4 3 West
- 5 Obstetrical Waiting Room

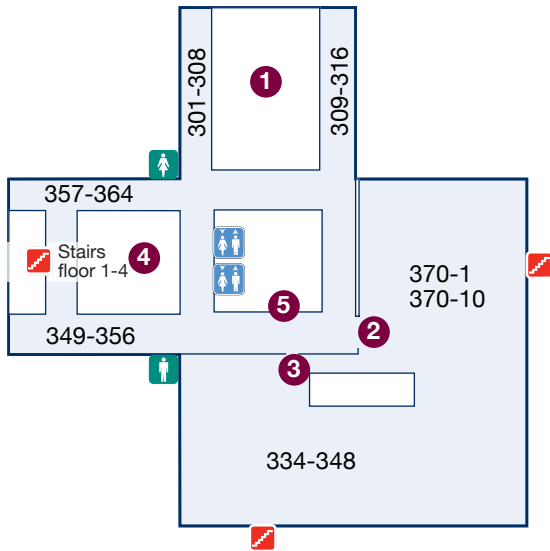

4th Floor

- 1 4 North
- 2 4 East
- 3 4 South
- 4 4 West
- 5 Family Waiting Room

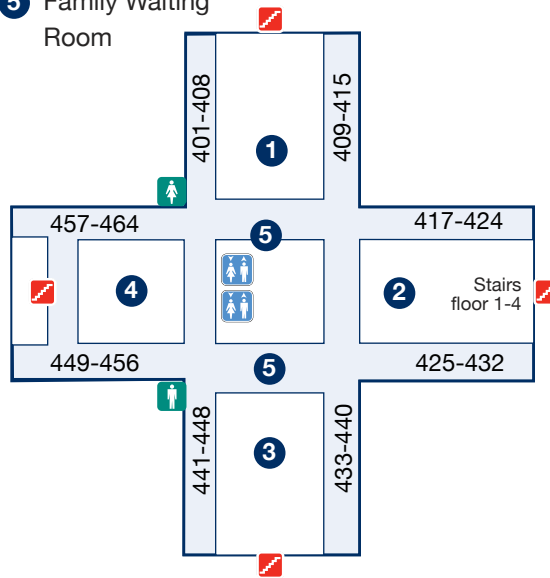

5th Floor

- 1 5 North
- 2 5 South
- 3 Family Waiting Room

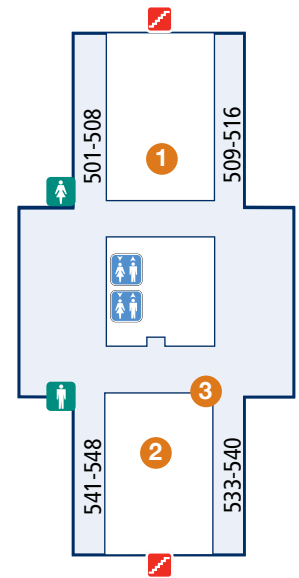

Campus Map

- A** Carondelet Medical Building
- B** The Medical Mall at St. Joseph Medical Center
- C** Saint Joseph Medical Building
- D** Community Center for Health and Education
- E** Carondelet Manor
- 1** Emergency Entrance
- 2** Saint Joseph Medical Building parking garage
- ▲ Visitor Parking
- ▲ Employee Parking
- Vendor Parking

